

Smart Car -- 2WD

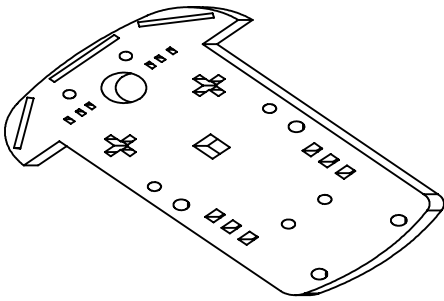

Chassis 1 pcs

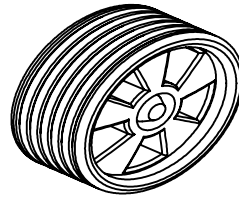

Wheel 2 pcs

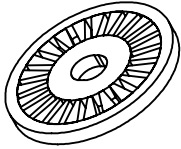

Velocimetry code wheel 2 pcs

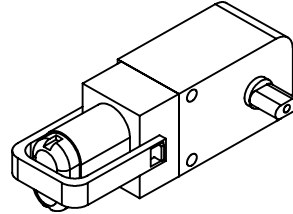

DC Gear Motor 2 pcs

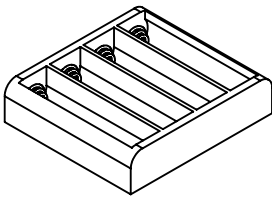

Battery container 1 pcs

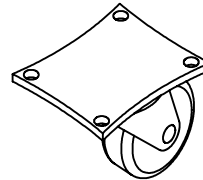

Universal wheel 1 pcs



M3*8 Screw 4 bars



M3 nut 8 pcs



M3*6 Screw 8 bars



L10 Spacer 4 bars

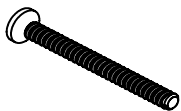

M3*30 Screw 4 bars

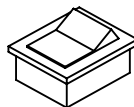

Switch 1 pcs



Fastener 4 pcs

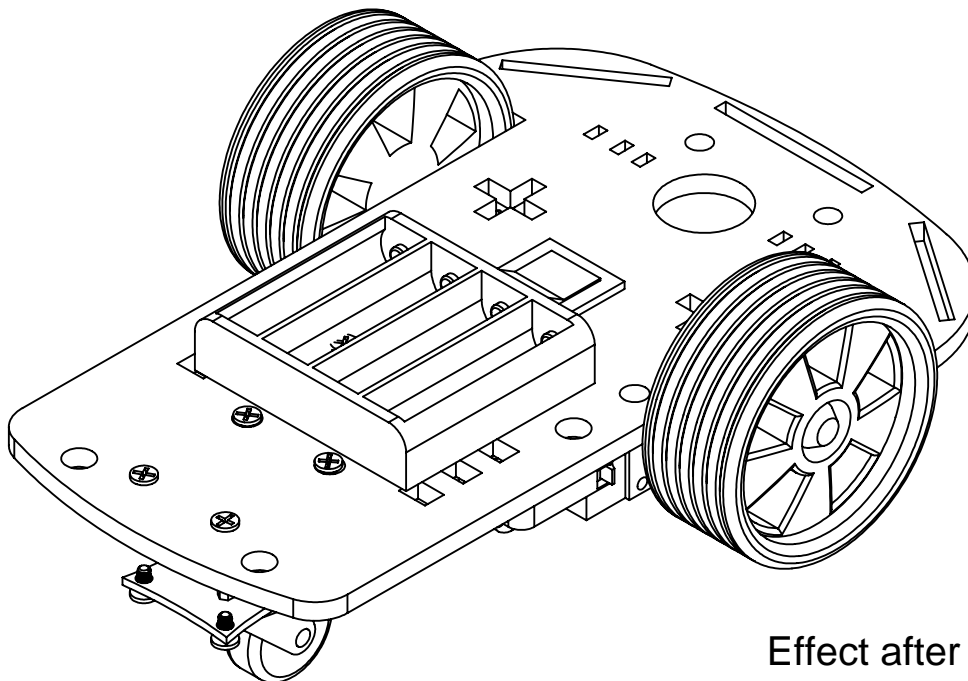

Effect after installation

Smart Car -- 2WD

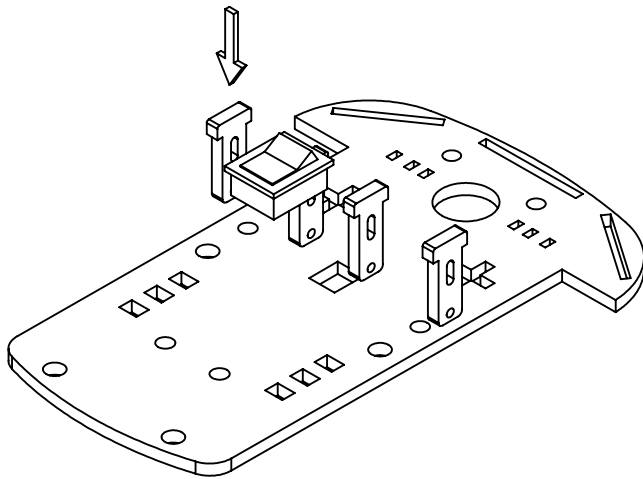

Setp1:Insert the fastener into the chassis after tearing off the yellow protection wrap of the chassis, the fastener and the code wheel.

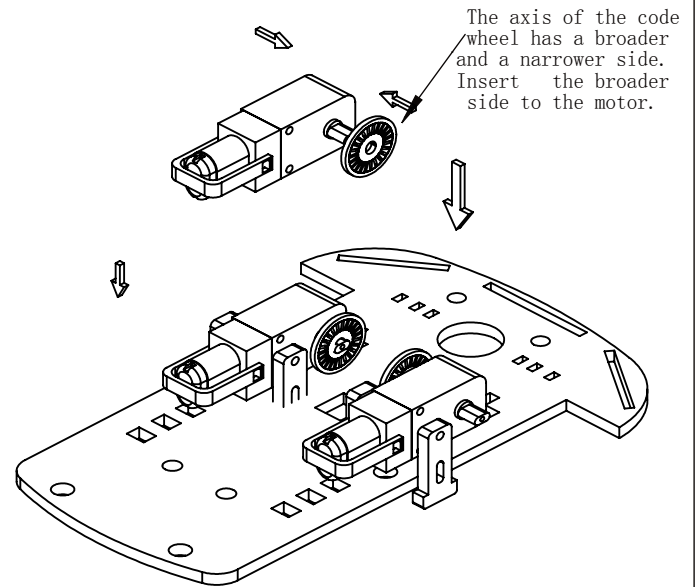

Setp2:Install the code wheel and fix the motor to the chassis. (Attention, the copper sheet of the leading wire of the motor should face outward, the same side of the wheel)

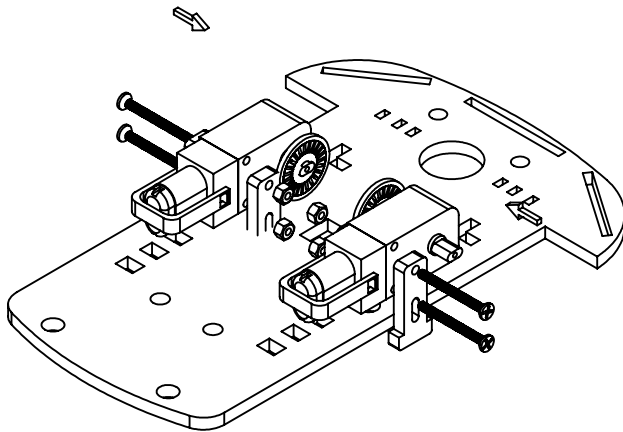

Setp3:Fix the motor to the chassis,then insert and tighten the screws.

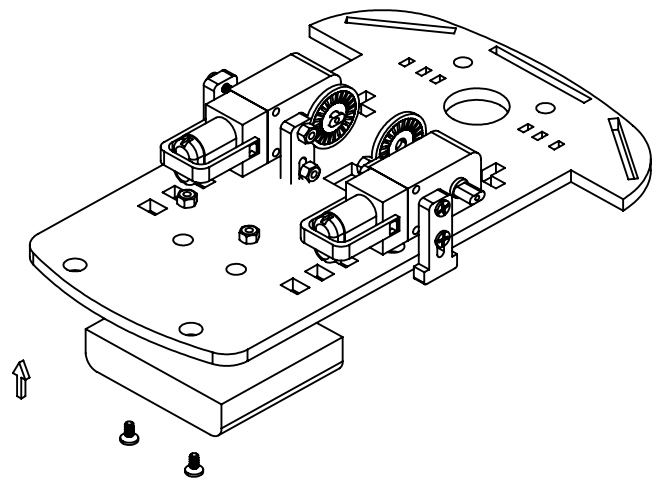

Setp4:Insert the screws and fix the battery container.

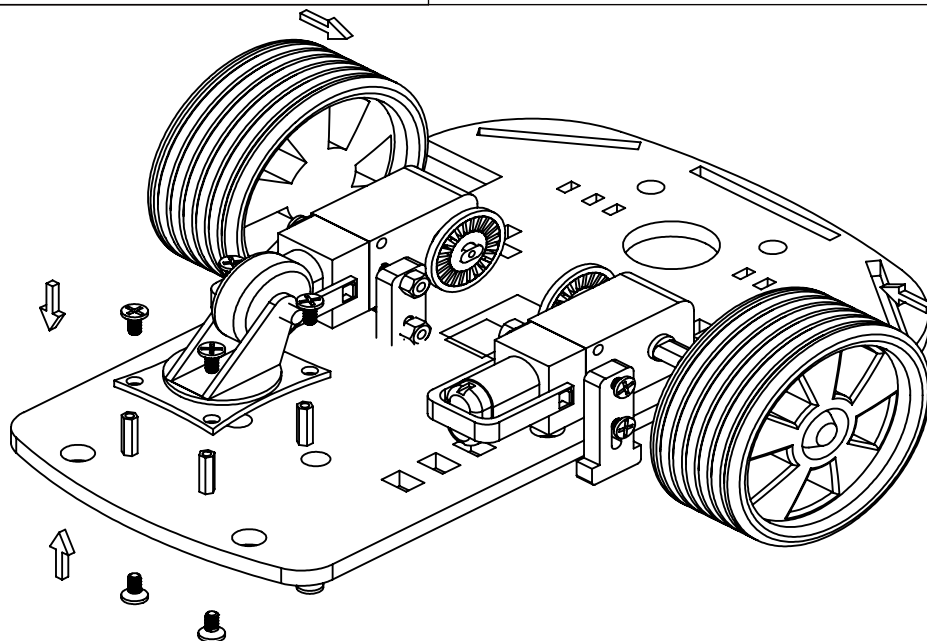

Setp5:Insert the spacer and tighten the 8 screws to fix the hammer caster. Hold tight and insert the motor(protection fastener) to the wheel.Installation completed.